



Base



The Base collection consists of basic-shaped basins especially designed for the contract market. It is characterized by the 12mm radius inside the basin. This collection aims to be accessible, adaptable and easy to maintain.

Not only is Base perfect for the domestic environment, but its characteristics also make Base an ideal choice in hygienic surroundings and intensively-used restrooms, such as hospitals, exhibition centers or airports.

Design by Marike Andeweg

○ White Himacs



Washbasin layout

Make a choice between a single or double bowl washbasin and fill in positions 1-5 or 1-6 accordingly. Next step is to define the size of the bowl(s) indicated by the - symbol. Go to page 24 and 25 for Base bowl sizes.

SINGLE

- bowl size
- ① max. 5000mm
- ② max. 550mm
- ③ min. 35mm
- ④ min. 30mm
- ⑤ min. 30mm
min. 50mm with overflow
min. 80mm with tap hole
min. 120mm with tap hole + overflow

Note: when ordering only a top with bowl(s), sizes 3, 4 and 5 need to be adjusted according to the cabinet construction.

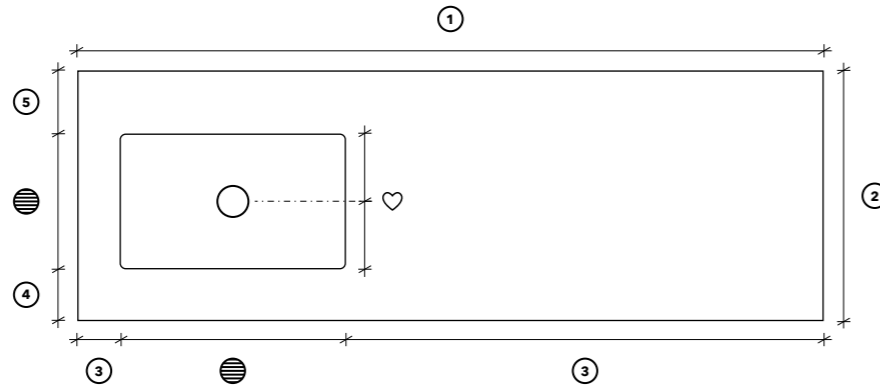

DOUBLE

- bowl size
- ① max. 5000mm
- ② max. 550mm
- ③ min. 35mm
- ④ min. 30mm
- ⑤ min. 30mm
min. 50mm with overflow
min. 80mm with tap hole
min. 120mm with tap hole + overflow
- ⑥ min. 50mm

Note: when ordering only a top with bowl(s), sizes 3, 4 and 5 need to be adjusted according to the cabinet construction.

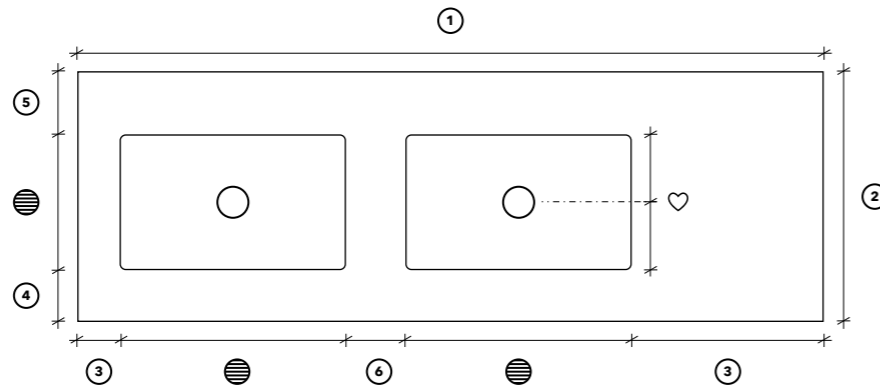

Edge

Base washbasin can be supplied with a 12mm top or with an edge from 20mm up to 900mm. In order to conceal the bowl, Not Only White recommends an edge height as mentioned on pages 24 and 25 at the 'Bowls' section.

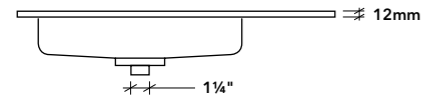

H12
12mm top sheet

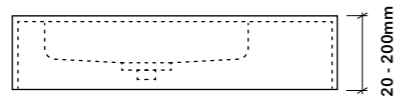

EH100
Edge 20 - 100mm high

EH150
Edge 101 - 150mm high

EH200
Edge 151 - 200mm high

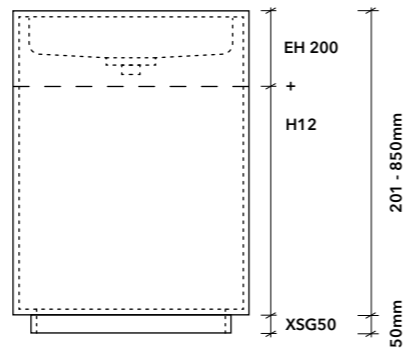

EH200 + remaining m² in H12
Edge 201 - 850mm high

XSG50
50mm plinth for floor-standing model

Tap hole

If you need to fit a top-mounted tap, we can pre-drill the hole (code **HH35**).

Consider the space you would need to secure the tap with a tightening ring.

Top-mounted tap without overflow:

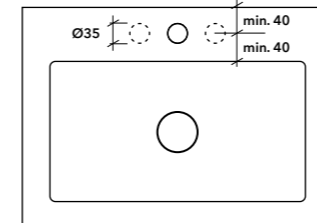

Top-mounted tap with overflow:

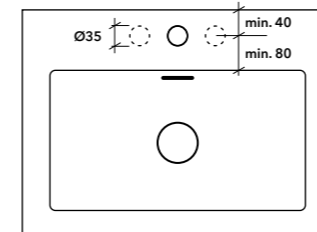

Basq trays

Base washbasin can be supplied with a plateau on the side for Basq trays. Please refer to page 10 and 45.

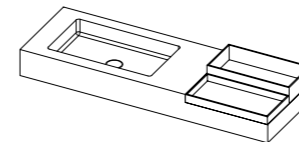

Brackets and ribs

Please refer to page 11, where brackets and ribs are explained, to find out what type of support is needed for your washbasin.

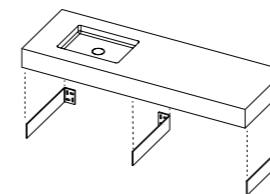

Drain type

Depending on how the washbasin needs to look and work, you can choose from different drain types for Base.

- ① **FLUSH DRAIN**
free flow drain ± 35
1 1/4"

Base bowls are standard equipped with our Flush drain. This drain allows water to flow through at all times and cannot be closed.

Flush drain is free of charge

- ② **POP-DOWN DRAIN**
closable drain ± 45
1 1/4"

Our Pop-down drain has the same aesthetic as the Flush drain but it can be pressed down to close the drain.

Pop-down drain is calculated per bowl

For use with the Pop-down drain, Not Only White recommends to equip the bowl with an overflow.

- ③ **DR72 DRAIN HOLE**
for a third party drain Ø72
± 20
Ø46

The DR72 drain hole is used for third party drains, both closable and non-closable.

DR72 drain is free of charge

Not Only White recommends to pair a third party closable drain with an overflow.

Note: when choosing a pop-down drain we recommend an overflow and extra edge height of 45mm. With a pop-down drain only we recommend an extra edge height of 15mm.

Overflow

An overflow (code **OH50**) is used for bowls equipped with a closable drain.

The overflow drain tube needs 50mm at the back of the washbasin to fit.

The overflow ring, that drains excess water into the drain, adds 30mm of height underneath the basin drain.

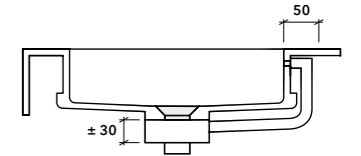

Integrated backsplash

Not Only White offers an integrated backsplash on Base washbasins (code **CSP90H**) with a maximum height of 90mm.

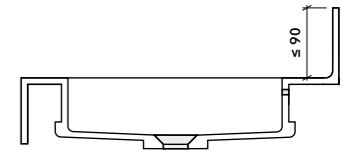

Note that a backsplash with a height over 90mm will be supplied as a separate piece without a radius edge.

Separate backsplash is calculated per m²

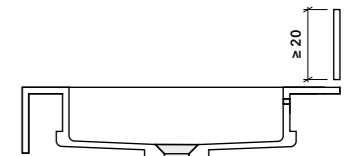

Cut-outs and edge finishes

Please refer to page 10.

Materials and colors

Himacs White

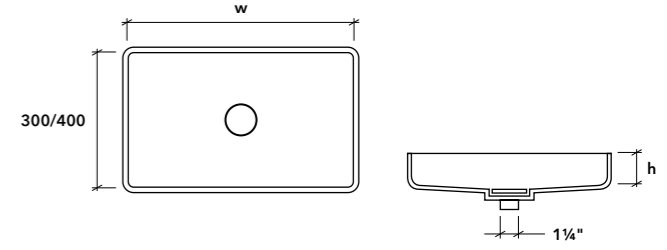
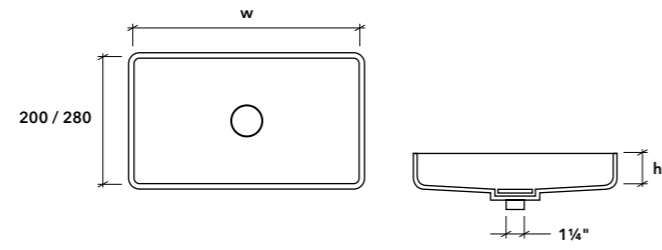

Bowls - 280mm

Bowls - depth 300mm

w400mm x d280mm

w1000mm x d280mm

w400mm x d300mm

w1000mm x d300mm

CBS40285
w400 x d280 x h50mm
rec. edge height 90mm

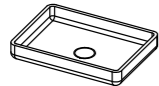

CBS100285
w1000 x d280 x h50mm
rec. edge height 100mm

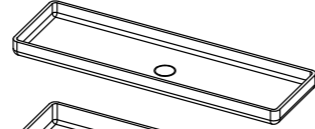

CBS40305
w400 x d300 x h50mm
rec. edge height 90mm

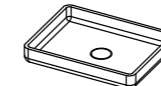

CBS100305
w1000 x d300 x h50mm
rec. edge height 100mm

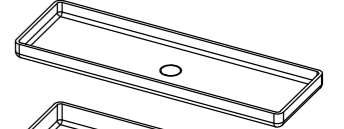

CBS40287
w400 x d280 x h75mm
rec. edge height 115mm

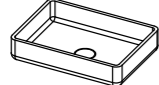

CBS100287
w1000 x d280 x h75mm
rec. edge height 125mm



CBS40307
w400 x d300 x h75mm
rec. edge height 115mm

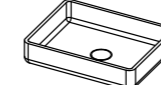

CBS100307
w1000 x d300 x h75mm
rec. edge height 125mm

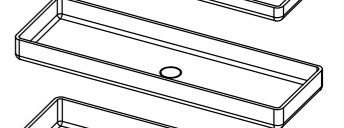

CBS402810
w400 x d280 x h100mm
rec. edge height 140mm

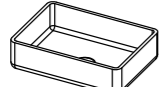

CBS1002810
w1000 x d280 x h100mm
rec. edge height 150mm

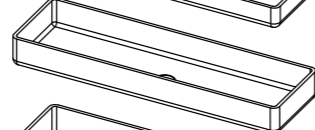

CBS403010
w400 x d300 x h100mm
rec. edge height 140mm

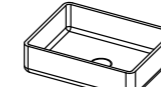

CBS1003010
w1000 x d300 x h100mm
rec. edge height 150mm



CBS402815
w400 x d280 x h150mm
rec. edge height 190mm

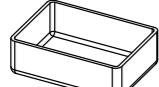

CBS1002815
w1000 x d280 x h150mm
rec. edge height 200mm



CBS403015
w400 x d300 x h150mm
rec. edge height 190mm

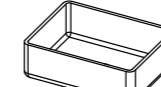

CBS1003015
w1000 x d300 x h150mm
rec. edge height 200mm



w500mm x d280mm

w500mm x d300mm

CBS50285
w500 x d280 x h50mm
rec. edge height 95mm

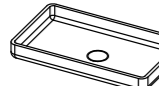

CBS50305
w500 x d300 x h50mm
rec. edge height 95mm

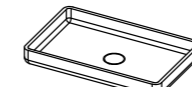

CBS50287
w500 x d280 x h75mm
rec. edge height 120mm



CBS50307
w500 x d300 x h75mm
rec. edge height 120mm

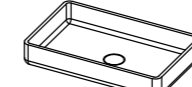

CBS502810
w500 x d280 x h100mm
rec. edge height 145mm

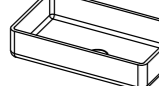

CBS503010
w500 x d300 x h100mm
rec. edge height 145mm



CBS502815
w500 x d280 x h150mm
rec. edge height 195mm

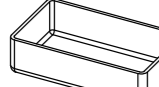

CBS503015
w500 x d300 x h150mm
rec. edge height 195mm

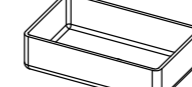

w800mm x d280mm

w300mm x d200mm

w800mm x d300mm

w400/500/650mm x d400mm

CBS80285
w800 x d280 x h50mm
rec. edge height 100mm

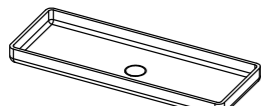

CBS30205
w300 x d200 x h50mm
rec. edge height 90mm



CBS80305
w800 x d300 x h50mm
rec. edge height 100mm

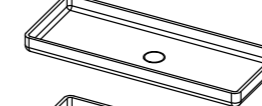

CBS80287
w800 x d280 x h75mm
rec. edge height 125mm



CBS30207
w300 x d200 x h75mm
rec. edge height 115mm



CBS80307
w800 x d300 x h75mm
rec. edge height 125mm



CBS802810
w800 x d280 x h100mm
rec. edge height 150mm



CBS302010
w300 x d200 x h100mm
rec. edge height 140mm

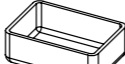

CBS803010
w800 x d300 x h100mm
rec. edge height 150mm



CBS802815
w800 x d280 x h150mm
rec. edge height 200mm



CBS302015
w300 x d200 x h150mm
rec. edge height 190mm

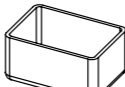

CBS803015
w800 x d300 x h150mm
rec. edge height 200mm



**For basin tops with a deep projection:
Bowls with depth of 400mm**

CBS404010
w400 x d400 x h100mm
rec. edge height 140mm

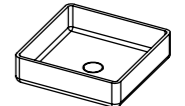

CBS504010
w500 x d400 x h100mm
rec. edge height 145mm

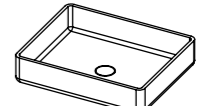

CBS654010
w650 x d400 x h100mm
rec. edge height 150mm

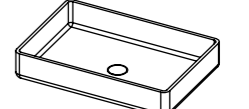

**For basin tops with short projection:
Bowls with depth of only 200mm**